



# SUNRAIN AWNING SHED

DAMEN CIVIL PRODUCT

## GENERAL

Ref/No	13330
Basic functions	Dry berthing / protection to sun & rain

## DIMENSIONS (APPROX.)

Length	60	m
Width	42,4	m
Height	22	m
Area	2546	m <sup>2</sup>
Volume	41700	m <sup>3</sup>
Weight	-	t

## CONSTRUCTION / FOUNDATION

This is all subject to the program of requirements, to the soil/surface and the purpose of the shed.

- Founded on piles or sheet pile foundation;
- Steel construction and (single layered) cladding;
- Concrete foundation works;
- Bearing & reinforced concrete floor or produced pavement.

## INSTALLATION

- Basic electrical;
- No illumination needed;
- Water installation;
- Compressed air system;
- Sewage and drainage (if requested).

## DESCRIPTION

Damen's Sunrain awning shed offers excellent protections against heat, wind, sun/light and rain during maintenance, service and construction works. It is a relatively low investment and offers the pleasure of working in a protected environment, free from (most of) the weather influences.

The shed can be your designated solution for numerous situations and will be modified to each desired configuration or plot. Materialization choices will have to be determined in close collaboration with the customer.

## OPTIONAL TOOLS AND EQUIPMENT

- Heavy lifting equipment;
- Blasting & painting equipment;
- Scaffolding;
- Tugs, Multicats and/or other workboats;
- Engine powered/electrical boom lift;
- Telehandlers/forklifts;
- Construction tools and lifting materials;
- Workshop tools & equipment;
- Workshop container (incl. tools & equipment).

## ADDITIONAL OPTIONS

- Completely closed shed with (wall) cladding;
- (automatic) sliding door(s) and/or overhead doors;
- Walk trough door(s);
- Overhead (traveling) crane;
- Lighting fixtures;
- Office units;
- Full elaborated electrical installation;
- Shower units and washing facilities;
- Power units/power packs.

# SUNRAIN AWNING SHED

DAMEN CIVIL PRODUCT



CONCEPT



REALISATION

MASTERPLAN

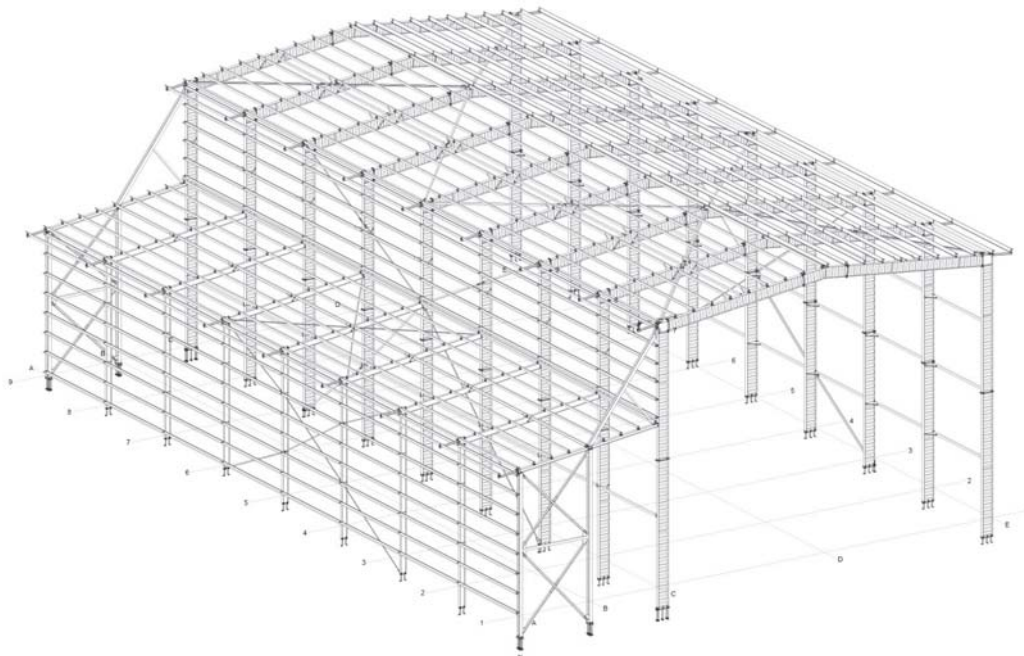

STEEL CONSTRUCTION

## DAMEN

DAMEN SHIPYARDS GROUP

Avelingen-West 20  
4202 MS Gorinchem  
The Netherlands

P.O. Box 1  
4200 AA Gorinchem  
The Netherlands

phone +31 (0)183 63 99 22  
fax +31 (0)183 63 21 89

info@damen.com  
[www.damencivil.com](http://www.damencivil.com)

© No part of the leaflet may be reproduced in any form, by print, photo print, microfilm, or any other means, without written permission from Damen Shipyards Group