

# CATWALK

DAMEN CIVIL PRODUCT

## GENERAL

Ref/No	13750
Basic functions	Mooring facility and accessibility

## DIMENSIONS (IN EXAMPLE ABOVE)

Length	45	m
Width	2	m
Height	-	m
Area	-	m <sup>2</sup>
Volume	-	m <sup>3</sup>

## CONSTRUCTION

- Steel or concrete pile foundation;
- Steel regulating structure with girders (prefabricated);
- Prefabricated upperstructure connected on steel pile foundation;
- Grid floor;
- Platform railing / balustrade.

## INSTALLATION

- Electrical installation;
- Electrical distribution boxes 127-220V and 440V;
- Compressed-air connection points;
- Dry riser (if requested) - fire extinguishing;
- Navigational / indication lights;

## DESCRIPTION

The Damen catwalk is an on steel or concrete piles supported jetty and can be used as an entrance way to get on - and reach specific places of - the vessels or as mooring place for the long term. Outfitting work can be performed when a vessel is moored at the catwalk.

The catwalk is also a perfect addition to a slipway and can be used to bring in vessels and create an easy way to secure vessels, attaching wire ropes for the winches or for instance to use/place capstans.

## TOOLS AND EQUIPMENT (OPTIONAL)

- Capstans;
- Heavy lifting equipment;
- Blasting & painting equipment;
- Scaffolding;
- Forklift;
- Tugs, Multicats and/or other workboats;
- Workshop container (incl. tools & equipment);
- Generator sets/Power packs.

## ADDITIONAL OPTIONS

- Varied dimensions and lay-outs for specific vessels;
- Gangways and bridges;
- Fenders & bollards;
- Longitudinal slipway;
- Transversal slipway;
- Transfer area;
- Safety equipment/materials;
- Street lighting;

# CATWALK

DAMEN CIVIL PRODUCT



## OVERVIEW

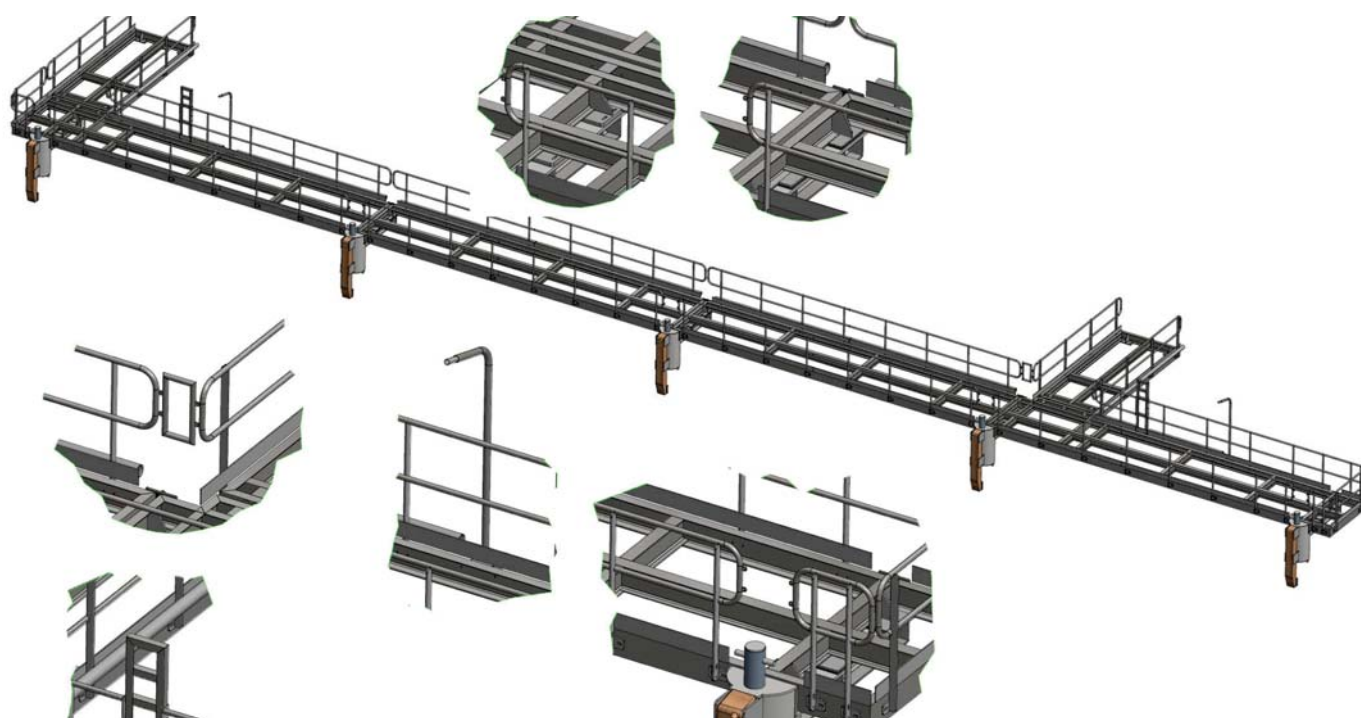

## STEEL CONSTRUCTION



DAMEN SHIPYARDS GROUP

Avelingen-West 20  
4202 MS Gorinchem  
The Netherlands

P.O. Box 1  
4200 AA Gorinchem  
The Netherlands

phone +31 (0)183 63 99 22  
fax +31 (0)183 63 21 89

info@damen.com  
[www.damencivil.com](http://www.damencivil.com)